

“Bridging Differences”

National Learner Centered Teaching &
North Central Region of the American Association for
Agricultural Education Conference
October 10 – 12, 2019
East Lansing, Michigan



National Conference on
Learner-Centered Teaching



Conference Partners



PURDUE
UNIVERSITY.

MICHIGAN STATE
UNIVERSITY

Conference Hosts

MICHIGAN STATE
UNIVERSITY

“Bridging Differences”
2019 NLCT & NC-AAAE Joint Conference
October 10-12, 2019
Michigan State University - East Lansing, Michigan

Thursday, October 10

Business Casual, Kellogg Center & Breslin Center

Note: Description and location of concurrent sessions provided starting on page 6.

- 8:00AM – 9:00AM Learner Centered Teaching Conference Registration and Refreshments (Kellogg Center Auditorium)
- 9:00AM – 9:30AM Opening Session & Welcome (Kellogg Center Auditorium)
Facilitator: Dr. Neil Knobloch, Purdue University
Welcome: Dr. Quentin Tyler, Michigan State University
- 9:30AM – 10:15AM Concurrent Learner-Centered Teaching (LCT) Session 1
- 10:15AM – 10:30AM Break
- 10:30AM – 11:15AM Concurrent LCT Session 2
- 11:15AM – 12:00PM Concurrent LCT Session 3
- 12:00PM – 1:30PM Lunch & Panel Discussion (Red Cedar AB)
The Journey of Being a Learner-Centered Teacher: From Innovation to Impact
Keynote Panel: Dr. Orlenthea McGowan, PI & Phillip Lewis (Langston University – Tulsa), Dr. Neil Knobloch, Co-PI (Purdue University) Dr. Wanda Newell (University of Arkansas – Pine Bluff), Dr. Cassandra Vaughn (Alcorn State University), & Dr. Bryan Hains (University of Kentucky)
- 1:30PM – 2:15PM Concurrent LCT Session 4
- 2:15PM – 2:30PM Refreshment Break (Kellogg Center Auditorium)
- 2:30PM – 3:15PM Concurrent LCT Session 5
- 3:15PM – 4:00PM Closing Session (Kellogg Center Auditorium)
Next Steps for Learner-Centered Teaching
Facilitators: Dr. Neil Knobloch (Purdue University) & Dr. Bryan Hains (University of Kentucky)
- 3:30PM – 5:00PM Registration (Kellogg Center Auditorium)
- 4:00PM – 5:00PM North Central AAAE Leadership Team Meeting (Room 103A)
- 5:00PM – 5:30PM Social & Cash Bar (Breslin Center Concourse)
- 5:30PM – 6:20PM Welcome (Breslin Center Concourse)
- 6:20PM – 7:30PM Dinner Buffet (Breslin Center Concourse)

“Bridging Differences”

2019 NLCT & NC-AAAE Joint Conference
October 10-12, 2019
Michigan State University - East Lansing, Michigan

7:30PM – 8:30PM	Innovative Idea Poster Session (Breslin Center Concourse) Guided Tours of Breslin Center
8:30PM – 9:15PM	First-Time Attendee & Student Orientation (Breslin Center, Meeting Room B, C, & D)

Friday, October 11

University Polo/Logo Day, Kellogg Center

Note: Description and location of concurrent sessions provided starting on page 6.

7:30AM	Poster Set-Up Available (Lincoln Room)
7:30AM – 8:00AM	Registration (Kellogg Center, Lincoln Room)
7:30AM – 9:30AM	Breakfast & Distinguished Abstract Session (Lincoln Room)
9:30AM – 9:45AM	Break
9:45AM – 11:00AM	NC-AAAE Research Session 1
11:00AM – 12:00PM	Professional Development Keynote Session (Lincoln Room)

Introduction to Inclusive Classroom Practices Using Intergroup Dialogue Methodology

Donna Rich Kaplowitz, Co-Director, The Program on Intergroup Relations, University of Michigan

In today's work and education environment, there is increased need for creating spaces where all individuals, regardless of race, gender, sexual orientation, social class and other social group identities feel welcome. This session is intended to introduce participants to the principles of creating an inclusive classroom environment. Techniques used in the 35 year-old Intergroup Dialogue methodology developed at the University of Michigan and used nationwide will be shared.

12:00PM – 1:00PM	Lunch (Lincoln Room)
1:00PM – 1:15PM	Break
1:15PM – 2:30PM	Professional Development Break-Out Sessions

Option 1: Workshop on Intergroup Dialogue Practices: Understanding Social Identity: Who I am and why it matters? (Lincoln Room)

Donna Rich Kaplowitz, Co-Director, The Program on Intergroup Relations, University of Michigan

This workshop is designed to allow participants to explore on a deeper level their own social identities and the impact of their social identities in society and their own work.

“Bridging Differences”

2019 NLCT & NC-AAAE Joint Conference
October 10-12, 2019
Michigan State University - East Lansing, Michigan

Option 2: Effective Collaboration Strategies Among 1890 and 1862 Land-Grant Universities

(Room 103A/B)

Neil Knobloch, Orlenthea McGowan, Phillip Lewis, John Sassin & Emily Harris

Langston University and Purdue University have collaborated on grant projects to advance faculty development and learner-centered teaching. This panel discussion will focus on opportunities, challenges, and strategies for Historically Black Colleges and Universities and Predominately White Universities to effectively collaborate.

Option 3: Introduction to Systems-Thinking and Modeling in AFNR Social Science Research

(Heritage Room)

Laura Schmitt-Olabisi, Associate Professor, Department of Community Sustainability, MSU & Steven Gray, Associate Professor, Department of Community Sustainability, MSU

This session is intended to introduce AFNR social science researchers to principles of systems thinking and modeling using easy-to-use and freely available software tools. Participants will learn how to access and use the Mental Modeler software (www.mentalmodeler.org) and understand how systems modeling can be applied to research in the AFNR social sciences.

2:30PM – 3:45PM	Committee Meetings <ul style="list-style-type: none">- Member Services Committee – Willy Room- Program Improvement Committee – Room 103A/B- Professional Development Committee – Heritage Room- Research Committee – Lincoln Room
3:45PM – 4:00PM	Refreshment Break (Lincoln Lobby)
4:00PM – 5:00PM	Round Table Session (Lincoln Room)
5:00PM – 6:00PM	Research Poster Session (Lincoln Room)

Saturday, October 12

Business Casual Attire, Kellogg Center

Note: Description and location of concurrent sessions provided starting on page 6.

7:30AM – 8:30AM	Breakfast & Follow-Up Committee Meetings Opportunity (Lincoln Room)
8:30AM – 9:45AM	Research Session 2
9:45AM – 10:00AM	Refreshment Break and Room Check-Out
10:00AM – 12:30PM	Awards and Business Meeting (Lincoln Room)

“Bridging Differences”

2019 NLCT & NC-AAAE Joint Conference

Student Experiences (Undergraduate & Graduate Students Welcome)

October 10-12, 2019

Michigan State University - East Lansing, Michigan

Thursday, October 10

Business Casual, Breslin Center

8:30PM – 9:15PM Student Introductions and Experience Orientation (Breslin Center, Meeting Room B, C, & D)

Friday, October 11

University Logo/Polo Day, Kellogg Center & AgroLiquid

11:00AM Meet in Kellogg Center Lobby for Travel to AgroLiquid (Transportation provided by Michigan State University)

11:30AM – 11:45AM Welcome and IQhub Presentation

11:45AM – 12:15PM Lunch (Provided by Michigan State University)

12:15PM – 1:15PM IQhub Tour

1:15PM – 1:30PM Travel to Research Farms

1:30PM – 3:30PM Research Farm Tours

3:30PM – 3:45PM Travel back to Conference

6:30PM – 8:00PM Meet in Kellogg Center Lobby for Campus Tour & Student Dinner: Organized by Michigan State University AFNR Education Club

Saturday, October 12

Business Casual, Kellogg Center

10:00AM – 12:30PM During the Business Meeting, you will be invited for a conference reflection and contact sharing activity (Kellogg Center Room 103A/B).

NLCTC Concurrent Session List

Thursday, October 10, 2019

Concurrent Session 1 (Kellogg Center, Thursday 9:30AM – 10:15AM)

103A: Using a Student Garden as a Learner-Centered Teaching Tool in Higher Education by Thomas H. Paulsen (Morningside College)

103B: Effects of Cooperative and Competitive Learning Strategies on Students' Achievement in Agricultural Ecology Using Concept Mapping in Secondary Schools in Anambra State by Dr. Juliana Ukonze & Chiamaka Akudili (University of Nigeria, Nsukka)

Auditorium: Innovative Learner-Centered Practices Across Multiple Disciplines by Dr. Wanda Y. Newell, Dr. Adrienne Robinson, Dr. Marilyn Bailey & Dr. Janette Wheat (University of Arkansas, Pine-Bluff)

Concurrent Session 2 (Kellogg Center, Thursday 10:30AM – 11:15AM)

103A: Development of On-line Tools to Enhance Learning Outcome Assessment in both Undergraduate and Graduate Programs by Dr. Rama Radhakrishna, Dr. John Ewing & Kaila Thorn (Pennsylvania State University)

103B: An Innovative Course: Learner-Centered Teaching in Integrated STEM through AFNR by Dr. Hui-Hui Wang & Bryanna Nelson (Purdue University)

Auditorium: Learner-Centered Teaching: Shaping Innovation for Today's Learning Environment by Dr. Phillip Lewis & Dr. Perry Sanders (Langston University – Tulsa)

Concurrent Session 3 (Kellogg Center, Thursday 11:15AM – 12:00PM)

103A: Learning Modules Focused on Learner-Centered, Knowledge-Centered, Assessment-Centered, and Community-Centered Environments by Dr. Nathan W. Conner (University of Nebraska – Lincoln) & Dr. Christopher T. Stripling (University of Tennessee)

103B: The Nexus of Mentoring and Learner-Centered Teaching (LCT) as an Approach to Enhance Diversity in Ag+STEM Disciplines by Dr. Levon Esters (Purdue University)

Auditorium: Learner-Centered Veterinary Surgery using Small Group Teaching in College Undergraduates by Dr. Cassandra Vaughn, Dr. Terrace Burks, Dr. Martha Ravola & Mrs. Edith Ezekwe (Alcorn State University)

Concurrent Session 4 (Kellogg Center, Thursday 1:30PM – 2:15PM)

103A: Metacognition: Thinking about Thinking and What It Means for Learners by Dr. R. Bud McKendree (Michigan State University)

103B: Strategies for Incorporating Theoretical Concepts to Survey Questions and Design by Dr. Rama Radhakrishna & Kaila Thorn (Pennsylvania State University)

Auditorium: Designing a Learner-Centered Course: Innovation Grounded in Collegiate Student Input by Dr. Leonard D. T. Newby, Dr. Desmond W. Delk (Langston University) & Dr. Melissa Brevetti (Langston University – OKC)

Concurrent Session 5 (Kellogg Center, Thursday 2:30PM – 3:15PM)

103A: Utilizing Cultural, Community, and Career Connections in the Classroom to Motivate the Next Generation of STEM Professionals by Ryan Kornegay & Elizabeth Alexander (Purdue University)

103B: Creating a Model for Preventing Academic Dishonesty in an Agricultural Program by Sam Bauman and Dr. Mark Zidon (University of Wisconsin, Platteville)

Auditorium: The Bumpy Road to LCT: Innovative Learner-Centered Teaching and Learning Initiatives by Dr. Orlenthea McGowan, Dr. John Sassin & Dr. Emily Patterson Harris (Langston University - Tulsa)

NC-AAAE Innovative Idea Poster Session

Thursday, October 10; 7:30PM – 8:30PM (Breslin Center)

A Framework for Linking Extension Program Delivery Methods to Program Outcomes. Rama Radhakrishna & Anil Kumar Chaudhary, Pennsylvania State University

Assessing Leadership Needs Among Extension Educators. Dr. Suzanna Windon & Mariah Stollar, The Pennsylvania State University.

Building Future Faculty and Leaders through Culturally Responsive Learner-Centered Teaching Partnerships. Dr. Orlenthea McGowan, Dr. Steve Zeng (Langston University), Dr. Neil Knobloch, Dr. Levon Esters (Purdue University), Dr. Phillip Lewis, Dr. Emily P. Harris, Dr. John Sassin, Dr. Dytisha Davis, Dr. Perry Sanders, Dr. Desmond Delk, Dr. Leonard Towns Newby, Dr. Melissa Brevett (Langston University) & Dr. Bryan Hains (University of Kentucky)

Collaboration in the Classroom: A Model Approach. Tony McCaul (Careerline Tech Center) & Aaron McKim (Michigan State University)

Creating a Visual Representation of a Cohorts Individual Assessments. Kindra Carr, Madison Quinn, Jessica M. Blythe & Haley Rosson, West Virginia University

EGGcellent Work: Utilizing a School-Based Enterprise SAE to Foster New Agricultural Experiences for Students. Melissia A. Grant & Sarah E. LaRose, Purdue University.

Exploring Undergraduate Perceived Learning and Skill Development in the Context of Community Engagement for Sustainability. Dr. Crystal L. Eustice and Dr. Michael W. Everett, Michigan State University

Farmer Education Clinic: A Paradigm for Farmers Greater Productivity in Nigeria. Dr. Juliana Ukonze & Dr. Okorhi Johnson, University of Nigeria, Nsukka

Peer Analysis as a Cooperative Learning Instructional Strategy. Lloyd Bell, University of Nebraska

Showcasing Agricultural Education Programs with Book Creator. Gaea Hock & Zachary Callaghan, Kansas State University

Using Non-Traditional Learning Partnerships to provide Experiential Teaching Opportunities. Katie Daughtry, Cole Payne, Travis Veech, Jessica M. Blythe & Jason McKibben, West Virginia University

Using Roger's Adoption Diffusion Attributes as a Precursor for Extension Program Development: Implications for Educators and Climate Science Specialists. Kaila Thorn and Rama Radhakrishna, Pennsylvania State University

When Three Become One, Impact of Three Academic Specializations Serving Students Through One Academic Organization. Rachael Ramsier & Joy Rumble, The Ohio State University

NC-AAAE Research Paper Sessions

October 10-12, 2019

Distinguished Abstract Session (Kellogg Center, Friday 8:00AM – 9:30AM)

Lincoln Room

Discussant: Dr. Thomas Paulson

Facilitator: Yu Lun Wu

Teacher Retention: A Relational Perspective

Eric M. Moser, Michigan State University

Aaron J. McKim, Michigan State University

Metacognition of Pre-service Teachers: A Phenomenology of Reflection-in-Action

Aaron J. Giorgi, The Ohio State University

Dr. Amanda M. Bowling, The Ohio State University

Dr. Caryn M. Filson, The Ohio State University

Prescribed Pedagogical Outcomes Versus Real-World Challenges: A Content Analysis of Kansas AFNR Course Competency Profiles

Zachary Callaghan, Kansas State University

Dr. Gaea Hock, Kansas State University

NC-AAAE Research Session 1 (Kellogg Center, Friday 9:45AM – 11:00AM)

Lincoln Room

Discussant: Dr. Anil Kumar Chaudhary

Facilitator: Aaron Giorgi

Success and Longevity Factors of North Dakota Agricultural Educators

Jenny Vandehoven, Medina High School, ND

Adam A. Marx, North Dakota State University

Motivational Beliefs of School Based Agricultural Education Teachers through Career Stages

Amanda Bowling, The Ohio State University

Amber Rice, University of Arizona

Kevin W. Curry, Pennsylvania State University

Adam A. Marx, North Dakota State University

Shared Motivational Beliefs of School Based Agricultural Education Teachers

Amanda Bowling, The Ohio State University

Amber Rice, University of Arizona

Kevin W. Curry, Pennsylvania State University

Adam A. Marx, North Dakota State University

Heritage Room

Discussant: Dr. Seburn Pense

Facilitator: Katie Daugherty

Secondary Agriculture Teachers' Knowledge, Beliefs and Teaching Practices of Climate Change

Bryanna Nelson, Purdue University

Dr. Hui-Hui Wang, Purdue University

Dr. Devarati Bhattacharya

University of Nebraska—Lincoln

Reaching Science Literacy through School-based Agricultural Education

Rosalind Cowan, The Pennsylvania State University

Dr. Kevin Curry, Jr., The Pennsylvania State University

Making the Jump: What Motivates Agricultural Education Instructors to Engage Students in Agriscience Research SAEs?

Brooke L. Thiel, North Dakota State University

Adam A. Marx, North Dakota State University

NC-AAAE Research Paper Sessions

October 10-12, 2019

Room 103A/B

Discussant: Dr. Jessica Blythe

Facilitator: Melanie Bloom

Kansas Ag Teachers' Perceptions of Diversity & Inclusion in Agricultural Education

Laura E. Miller, Kansas State University

Dr. Gaea Hock, Kansas State University

Dr. Jon Ulmer, Kansas State University

Dr. Jason Ellis, Kansas State University

The Shortage of Licensed Secondary Agriculture Instructors in Illinois: An Examination of the Impact on Secondary Agricultural Education Program Quality

Howard K. Heavner, Southern Illinois University

Seburn L. Pense, Southern Illinois University

Logan O. Park, Southern Illinois University

Teacher Perceptions of the Impact and Challenges of Middle School Agricultural Education Experiences in Kansas

Anna Williamson, Kansas State University

Dr. Gaea Hock, Kansas State University

Dr. Jon Ulmer, Kansas State University

Dr. Lori Goodson, Kansas State University

NC-AAAE Research Session 2 (Kellogg Center, Saturday 8:30AM – 9:45AM)

Lincoln Room

Discussant: Dr. Daniel Foster

Facilitator: Madison Quinn

Women Advocates' Approaches to Using Instagram

Emily Warnimont, The Ohio State University

Annie R. Specht, The Ohio State University

How Gender Plays a Role in Explaining Differences in Water Conservation Practices of Urban Homeowners?

Anil Kumar Chaudhary, The Pennsylvania State University

Elsie Assan, The Pennsylvania State University

Laura A. Warner, University of Florida

The Contributions of George Washington Owens to the Development of Agricultural Education Opportunities for African Americans

Zachary Callaghan, Kansas State University

Dr. Gaea Hock, Kansas State University

Heritage Room

Discussant: Dr. John Tummons

Facilitator: Jason Hughes

Agricultural Education Teachers Knowledge and Perceptions of Service-Learning

Trenton Smedley, Kansas State University

Dr. Jonathan D. Ulmer, Kansas State University

An Examination of the Curriculum for Agricultural Science Education (CASE) Certified Educators Perceptions of the Curriculums

Lauren Devine, West Virginia University

Jessica M. Blythe, West Virginia University

NC-AAAE Research Paper Sessions

October 10 - 12, 2019

Heritage Room - Continued

Discussant: Dr. John Tummons

Facilitator: Jason Hughes

Agricultural Teacher Perceptions of Facilitating Inquiry-Based Instruction Following a Yearlong Professional Development Experience

Matthew Kreifels, University of Nebraska-Lincoln

Nathan Conner, University of Nebraska-Lincoln

Bryan Reiling, University of Nebraska-Lincoln

Christopher Stripling, University of Tennessee

Mark Balschweid, University of Nebraska-Lincoln

Room 103 A/B

Discussant: Dr. Mark Zidon

Facilitator: Kindra Carr

Perceived Teaching Professional Development Needs and Self-Efficacy for Faculty at Non-Land-Grant Colleges of Agriculture

Lucas Maxwell, Illinois State University

Will Bird, University of Tennessee at Martin

Anna Ball, University of Illinois, Urbana-Champaign

Engaging Virtual Volunteers in Agricultural Teacher Education: The Volunteers' Perspective

Tiffany Morey, The Pennsylvania State University

Becky Haddad, Oregon State University

Daniel Foster, The Pennsylvania State University

The Dualism of Interdisciplinarity: A Model for Research and Practice

Aaron J. McKim, Michigan State University

NC-AAAE Research Round-Table Presentations

Friday, October 11; 4:00PM – 5:00PM (Lincoln Room, Kellogg Center)

Note: Three 20 minutes rotations.

Leveraging Technology to Connect & Prepare Preservice Educators
Sara LaRose, Purdue University

The Missouri Integrated STEM Internship Program
Rebecca Mott, University of Missouri

Global Learning in Agriculture: How can we help move the needle?
Daniel Foster, The Pennsylvania State University

Strategies for a Program of Action to Increase Diversity and Inclusion in Agricultural & Extension Education Programs

Mallen L. Marlowe, Rama Radhakrishna, & Patreese Ingram, The Pennsylvania State University

Reimagining the Agricultural Capstone Course: Identifying Relevant Strategies and Potential Collaborative Research Opportunities

Thomas Paulson, Morningside College

Climate Change and Agricultural Sciences: A Need for Undergraduate Curricula

Kaila Thorn & Rama Radhakrishna, The Pennsylvania State University

NC-AAAE Research Poster Session

Friday, October 11; 5:00PM – 6:00PM (Lincoln Room, Kellogg Center)

A Comparison of Faculty and Student Perceptions Toward Academic Dishonesty in an Agricultural Program at University of Wisconsin-Platteville. Sam Bauman & Dr. Mark Zidon, University of Wisconsin-Platteville

A Districtwide Look at Agricultural Educators Perceptions of Standards Based Grading. Lauren Worley, Dr. Jonathan Ulmer, Dr. Katie Burke & Dr. Gaea Hock, Kansas State University

An Examination of All-Terrain Vehicle (ATV) Usage Behaviors of Youth Participating in a School-Based ATV Safety Training Program. Dr. Haley Rosson, Dr. William Weeks & Dr. Penny Pennington Weeks, West Virginia University

Comparing Perceived Undergraduate and Programmatic Learning Outcomes in a Department of Community Sustainability. Jack Rumery, Dr. Crystal L. Eustice & Dr. Michael W. Everett, Michigan State University

Examining Agricultural Students Experiences and Skills in an Agricultural Capstone Course. Skyler P. Rinker, Dr. Mark Hainline & Dr. Scott Smalley, Iowa State University

Examining secondary talented and gifted and agricultural education experiences relative to college major and career choice. Darcie Gallagher, Dr. Jonathan Ulmer, Dr. Gaea Hock, & Dr. Jason Ellis, Kansas State University

Perceptions of Agricultural Educators Entering the Profession through Alternative Means. Allison Faivre, Scott Smalley & Mark Hainline, Iowa State University

Science Efficacy of Agriculture Education and Science Teachers Participating in a Professional Development Program. Jesse Bower, Dr. Bryan Reiling, Dr. Nathan Conner, Matt Kreifels & Dr. Mark Balschweid, University of Nebraska

Transitioning from Mid-Career to Veteran Teacher Status. Laura Hasselquist & Nicole A. Graves, South Dakota State University

Win, Lose, or Draw: Games in AFNR Education. Aaron J. McKim, Robert B. McKendree & Catlin M. Pauley, Michigan State University

North Central Officers

Name	Office	Term Ends
Roger Tormoehlen	Vice President	2020
Neil Knobloch	Vice President Elect	2020
Jessica Blythe	Secretary/Treasurer	2020

Member Services Committee

Name	Office	Term Ends
Jason McKibben	Chair	2019
TBD	Vice-Chair	
Kevin Curry	Member	2020
Brandie Disberger	Member	2020
Mark Russell	Member	2021
Scott Smalley	Member	2021
Jon Ulmer	Member	2019

Program Improvement Committee

Name	Office	Term Ends
Gaea Hock	Chair	2019
Laura Hasselquist	Vice-Chair	2020
Mark Hainline	Member	2020
Jon Simonsen	Member	2019
Annie Specht	Member	2021
Allen Talbert	Member	2021

Professional Development Committee

Name	Office	Term Ends
Aaron McKim	Chair	2019
Buddy McKendree	Vice-Chair	2020
TBD	Member	2020
Anil Kumar Chaudhary	Member	2021
Sarah LaRose	Member	2021
Emily Perdue	Member	2019

Research Committee

Name	Office	Term Ends
Hui Hui Wang	Chair	2019
John Tummons	Vice-Chair	2020
Amanda Bowling	Member	2021
Misty Lambert	Member	2020
Adam Marx	Member	2021
Tom Paulsen	Member	2019

JAE Managing Board

Name	Office	Term Ends
Ryan Anderson	Member	2019
Misty Lambert	Member	2020
Hui-Hui Wang	Member	2021

Maps

Kellogg Center

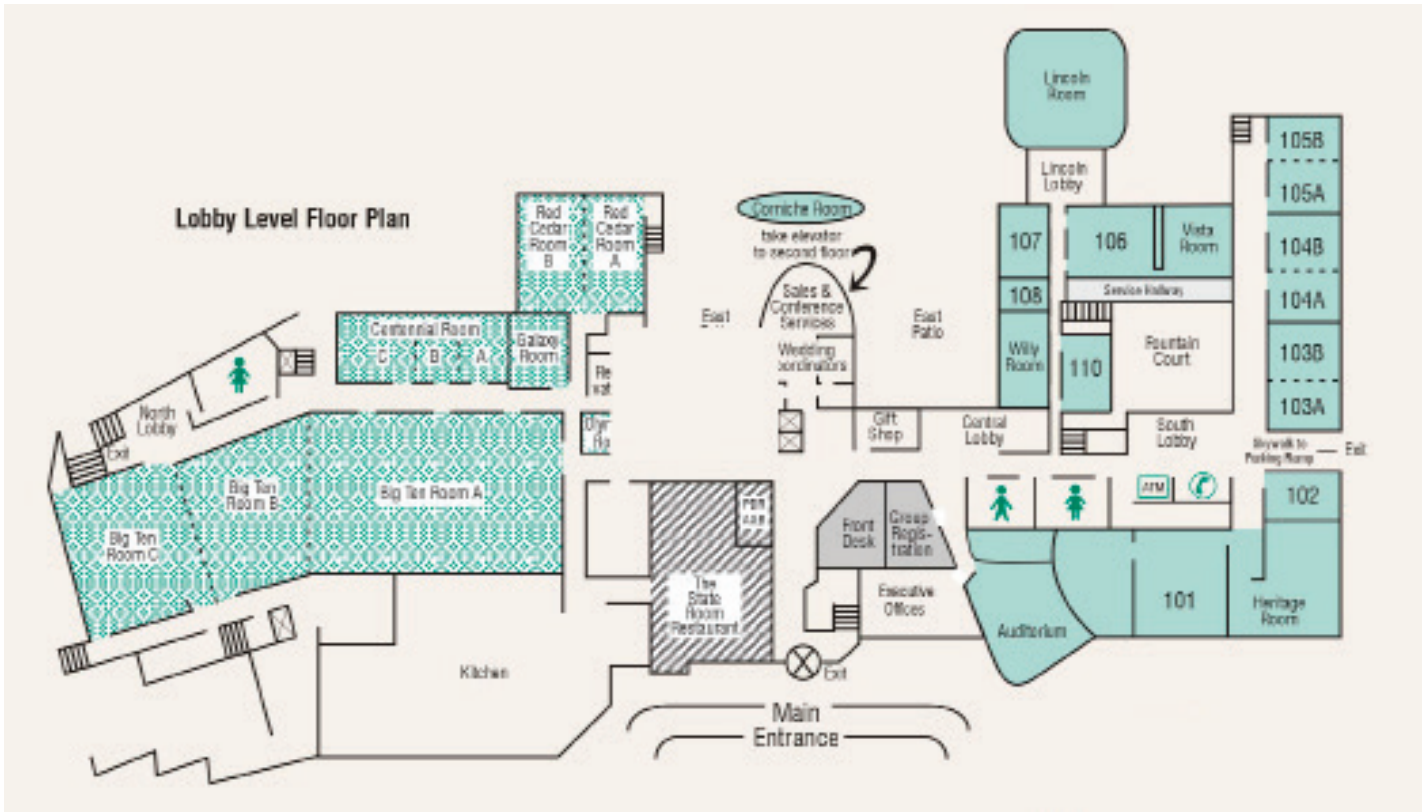

Kellogg Center to the Breslin Center



Directions to Thursday's
Welcome, Dinner, and
Innovative Idea Poster
Session

National Conference on
Learner-Centered Teaching



MICHIGAN STATE

U N I V E R S I T Y

